

## BULKHEAD FITTING

Supplied complete with compression nut and sleeve.

Product Code	A Diameter	B mm	C mm	D mm	Clear Hole mm
BPA 3/1	3/16"	8	25	13	10
BPA 3/2	3/16"	14	32	13	10
BPA 4/1	1/4" OD	12	32	13	11.5
BPA 4/2	1/4" OD	20	38	13	11.5
BPA 6M/1	6mm OD	12	32	13	11.5
BPA 6M/2	6mm OD	20	38	13	11.5

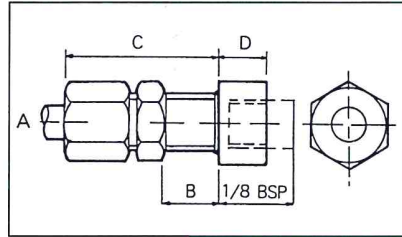

Material - BRASS Finish - NATURAL

## COMPRESSION NUT (optional for use with above)

Product Code	A Diameter	B Thread	C mm	D mm	E mm
BPA 3/N	3/16" OD	1/8" BSP	10.5	8	11
BPA 4/N	1/4" OD	11mm x 1	12	8	14
BPA 6M/N	6mm OD	11mm x 1	12	8	14

Material - BRASS Finish - NATURAL

## COMPRESSION SLEEVE (optional for use with above)

Product Code	A Diameter	B mm	C mm
BPA 3/S	3/16" ID	6.5	7
BPA 4/S	1/4" ID	6.5	8.5
BPA 6M/S	6mm OD	6.5	8

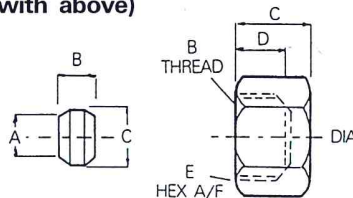

Material - BRASS Finish - NATURAL

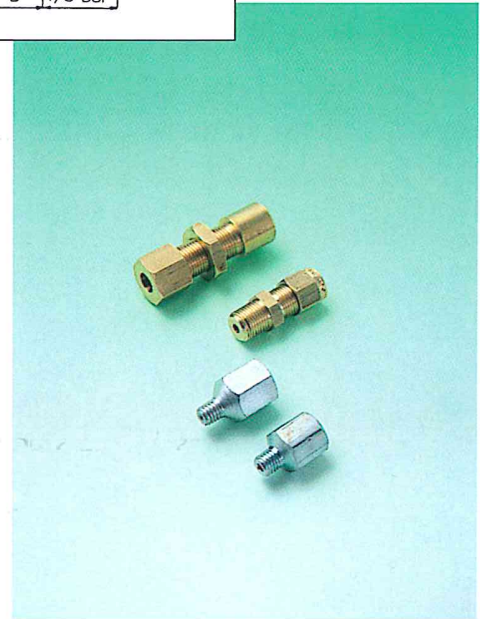

## STRAIGHT FITTINGS

Supplied with compression nut and sleeve

Product Code	Tube OD	A Thread	B mm	C mm	D mm	E mm	Suitable Nut	Suitable Sleeve
7061	3/16"	1/8" BSP	16	9.5	11.30	11.30	1001	1021
7063/1	1/4"	1/8" BSP	18.4	9.5	13.30	15.7	1003	1023

Material - BRASS Finish - NATURAL

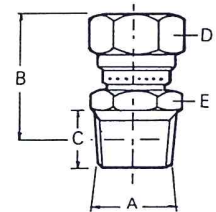

Not supplied with compression nut and sleeve. See opposite sheet for details.

Product Code	Tube OD	A Thread	B Thread	C mm	D mm	E mm	Suitable Nut	Suitable Sleeve
LV 90069	6mm	M6x1	M10x1	22	7	13		
LV 90059	6mm	M8x1	M10x1	21	7	13		
LV 90067	6mm	M8x1.25	M10x1	22	6	13	LV 90460	LV 90560
LV 90060	6mm	M10x1	M10x1	18	6	13		
LV 90068	6mm	M10x1.5	M10x1	20	6	13		
LV 90062	6mm	1/8" BSP	M10x1	18	6	13		

Material - BRASS Finish - NATURAL

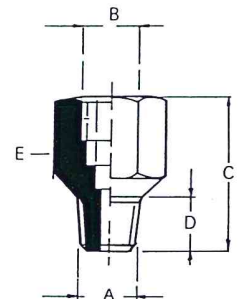

Not for use with compression nut and sleeve.

Product Code	A Thread	B Thread	C mm	D mm	E mm
50-1202-02	1/4" UNF	1/8" BSP	19	6.35	12.7
50-1202-03	5/16" UNF	1/8" BSP	19	8	12.7

Material - STEEL Finish - ZINC PLATED.

